

SHIMANO®

1987 REPAIR MANUAL

Shimano American Corporation, One Shimano Dr.
Irvine, CA 92718

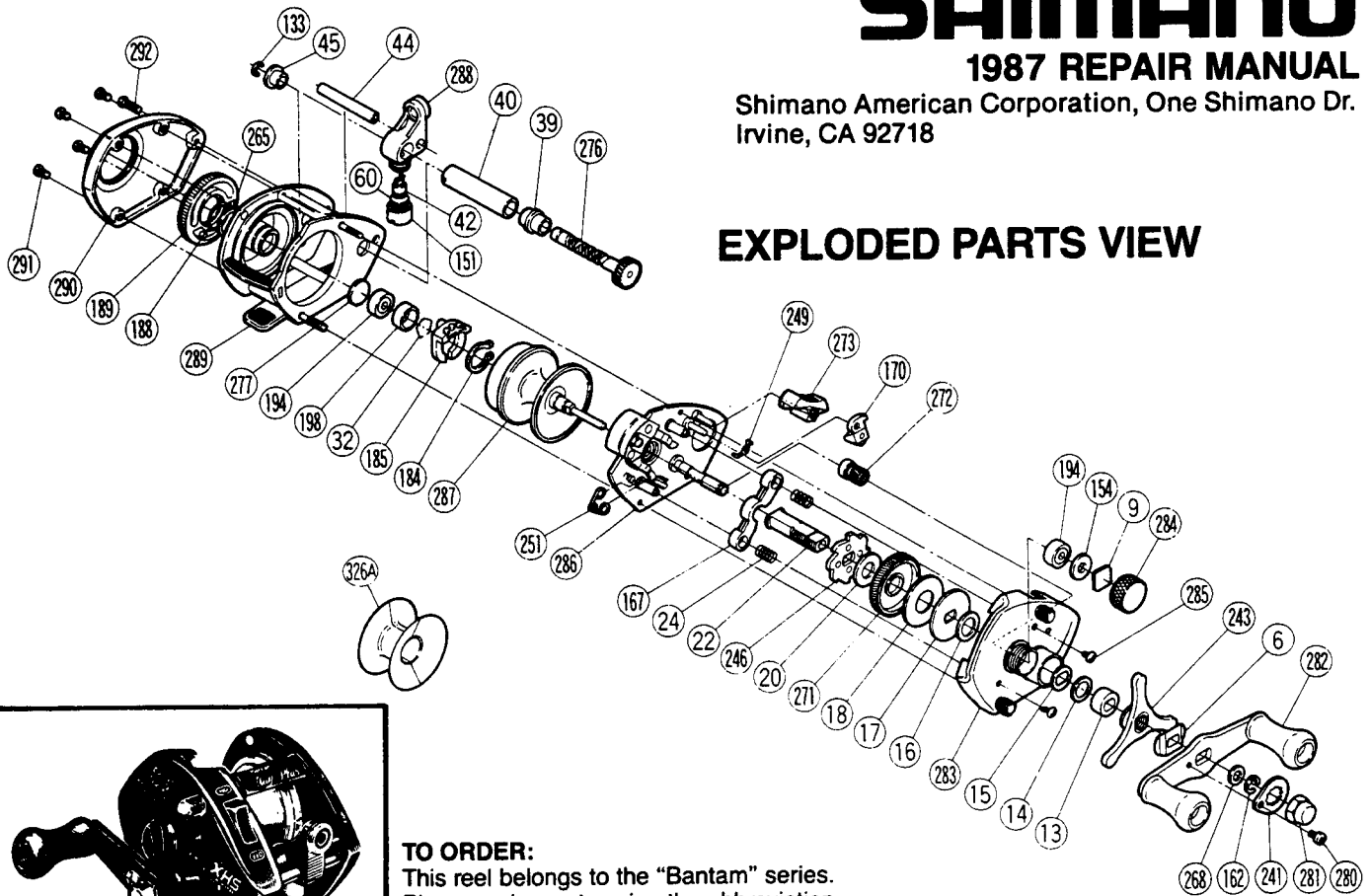

EXPLODED PARTS VIEW

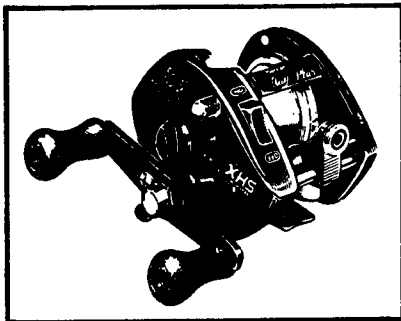

TO ORDER:

This reel belongs to the "Bantam" series.
Please order parts using the abbreviation
"BNT" and the part number.

BANTAM® MAG PLUS-TM 150 SG

PARTS LIST

PART# DESCRIPTION

- 6. Friction Washer
- 9. Cast Control Spacer
- 13. Drive Shaft Bearing
- 14. Drag Spring Washer
- 15. "D" Washer
- 16. Drag Spacer
- 17. Pressure Plate
- 18. Drag Washer
- 20. Base Drag Washer
- 22. Drive Shaft
- 24. Pinion Yoke Spring
- 32. Bearing Lock
- 39. Level Wind Bearing Right
- 40. Level Wind Guard
- 42. Level Wind Pawl
- 44. Stabilizer Bar
- 45. Level Wind Bearing Left
- 60. Pawl Shim (optional)
- 133. Level Wind Gear Lock

PART# DESCRIPTION

- 151. Pawl Cap
- 154. Felt Oil Retainer
- 162. "C" Lock
- 167. Pinion Yoke
- 170. Anti Reverse Dog
- 184. Magnet Retainer Lock
- 185. Magnet Retainer
- 188. O Ring
- 189. Magnetic Control Dial
- 194. Spool Shaft Bearing
- 198. Bearing Spacer
- 241. Handle Nut Lock Plate
- 243. Drag Tri-Star
- 246. Anti Reverse Ratchet
- 249. Switch Spring
- 251. Retractor Spring
- 265. Thrust Washer
- 268. Drive Shaft Shim
- 271. Drive Gear

PART# DESCRIPTION

- 272. Pinion Gear
- 273. Anti Reverse Switch
- 276. Level Wind Gear
- 277. Left Bearing Spacer
- 280. Handle Nut Lock Screw
- 281. Handle Nut
- 282. Handle
- 283. Right Side Plate
- 284. Cast Control Cap
- 285. Right Side Plate Screw
- 286. Set Plate
- 287. Spool
- 288. Line Guide
- 289. Frame
- 290. Left Side Plate
- 291. Left Side Plate Screw
- 292. Left Stabilizer Bar Screw
- 326A. V Spool Converter